



# USING PDF IN POWERPOINT

## ENHANCE PRESENTATIONS WITH PDF VECTOR GRAPHICS



Use **pdf2picture** or **PDF FLY** to convert your PDF files into vector formats that Microsoft® PowerPoint® can digest. WMF and EMF are native Microsoft Windows vector graphic formats and SVG is the standard Web format.

## INSERT PICTURE

Use “**Insert Pictures**” on the PowerPoint ribbon or drag the WMF, EMF or SVG directly onto a slide.

You should now see the graphic on the PowerPoint slide. **Ungroup** the image by right-clicking to select “**Group, Ungroup**”. Click anywhere outside the picture to deselect all objects. Now you can add, edit and remove individual elements.

If you want to scale the drawing, make sure you “**regroup**” it by selecting **Group, Regroup** so that everything is reconstructed and scaled proportionately.

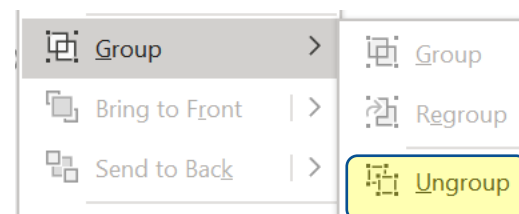
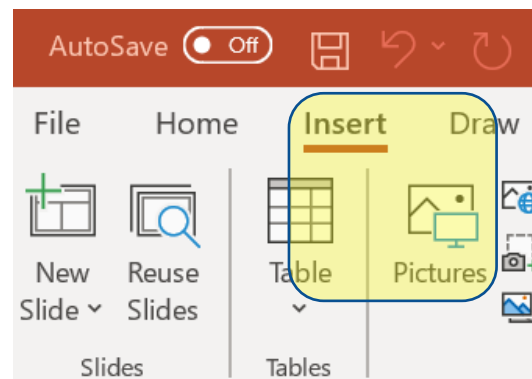

## Even Easier?

[Insert PDF in PowerPoint](#) is an add-in which opens a PDF file as an editable slide. It does all this work for you! [Free 15-day Trial](#).